



# THERMAL WINDOWS



Built to last.®

EAB's thermal windows with fixed glazed sections are completely maintenance-free and very durable, thanks to their galvanised, welded steel profiles.



# FACTS

We manufacture out thermal windows exactly according to your wants and needs in terms of measurements and choice of colour. You choose the number of lights yourself. The maximum glazing surface is 1.2 m<sup>2</sup> and the maximum length is 6 metres.

## Glazing

The thermal windows are supplied with insulating glazing D4-18, U-value 1.1, fitted with strong strips of natural anodised aluminium. Other types of glazing can be fitted upon request.

## Installation

M16 frame bushing for wall installation, alternatively, plate angle included. Recommended mounting screws Ø 7.5 type Hilti

alternatively Tema frame screws are not included.

## Surface treatment

Hot-dip galvanised steel tubular profiles.

## Optional, sheet metal cladding

The exterior is clad with lacquered sheet metal profiles, see separate colour range.

## Material

- Frame and dividers made of hot-dip galvanised steel profiles.
- Insulation profiles made of ABS, zinc grey colour.
- Interior and exterior glazing strips of natural anodised aluminium.



Thermal window with grey cladding.

## MAINTENANCE FREE

The thermal windows are maintenance-free, have hot-dip galvanised steel profiles and a thermal break in the cold bridge. The windows are designed for solid glazing and are manufactured according to your measurements. You choose the number of light sections yourself. The maximum glazing surface is 1.2 m<sup>2</sup> and the maximum length is 6 metres.

## CLADDING

The inside is hot-dip galvanised and the outside is a weatherproof insulation profile. The outside is clad with lacquered metal profiles in one of our standard colours, see the colour range.

## 10 YEAR GUARANTEE

We know that our doors last. That's why they always come with a 10-year guarantee, regardless of which the solution you choose. Each door is made in Smålandsstenar, Sweden. We have mastered the art of combining design, function and durability.



Exterior with sheet metal cladding.



Hot-dip galvanised frame interior.



Fastening with frame screws.



Fastening with plate angle.

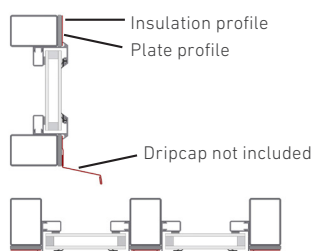

Built to last.\*

STORAGE EQUIPMENT | DOORS | STEEL BUILDINGS  
333 33 SMÅLANDSSTENAR | +46 371 340 00 | WWW.EAB.INFO

