



LIVE STORAGE RACKING



Built to last.®

EAB's live storage racking are used for highly effective picking of goods on pallet racking. This ensures that the goods are loaded in and out according to a given order.

I RÄTT LÄGE MED RULLBANOR

EAB's live storage racking are used for highly effective picking of goods on pallet racking in accordance with the FIFO (first in, first out) and FILO (first in, last out) principles. This ensures that the goods are loaded in and out according to a given order, because the right goods always end up at the front, ready for collection

Safety requirements

EAB's live storage racking fulfil the European Standards for pallet racking, EN 15512, EN 15620, EN 15629 and EN 15635.

Surface finish

Beams are lacquered orange. Frames and other parts galvanized.

Delivery

All installations are planned and CAD-designed by our planning department. For assembly, we recommend using our experienced fitters. All deliveries include an installation sign that should be clearly visible.

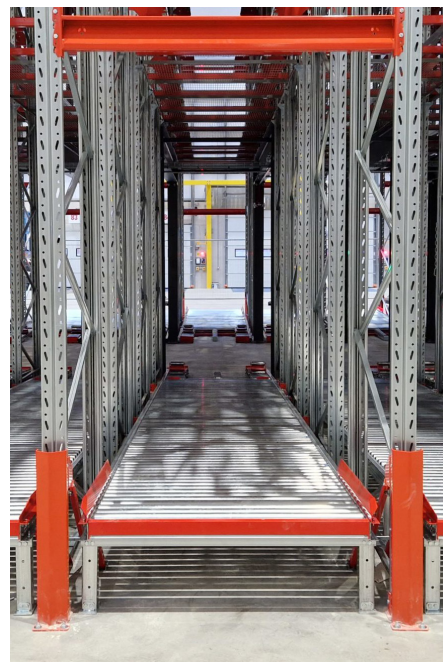

MAXIMISE SPACE

Live storage racking allow you to minimise the number of truck lanes and maximise your warehouse space.

FIFO OR FILO?

We supply two types of live storage, straight through racks FIFO (first in, first out) and pushback racks FILO (first in, last out). The right pallet always ends up in the right place.

FLEXIBLE

Live storage racking work in all temperature environments and are suitable for cold storage, freezers, one-piece flow and multiple parallel flows.

We adapt and design the racking system to meet your specific needs.



Pallet flow racks | In straight through racks, goods are managed according to FIFO (first in, first out). The goods are loaded into the pallet rack from one side and unloaded from the other. This provides a very satisfactory flow of goods, for example, when managing goods with a limited storage life. The straight through rack is fitted with brake rollers at regular intervals so that the goods are transported safely.

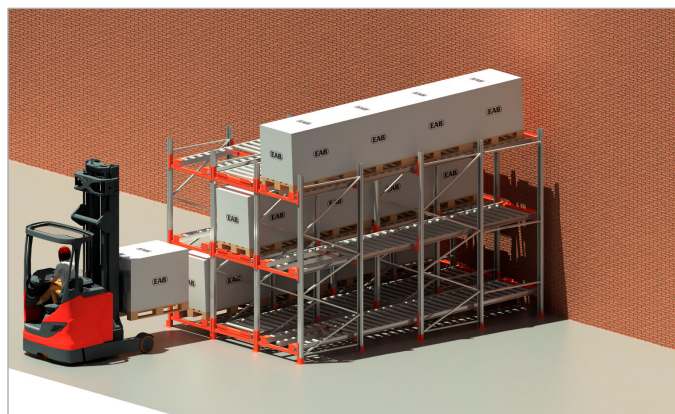

Push back rack | In EAB's push back rack, goods are managed according to the FILO Principle (first in, last out). The truck pushes the pallets into the rack and loading and unloading take place from the same side. This type of storage only requires one truck aisle, which saves a lot of space as the rack can be placed against a wall.



For more information, visit eab.info or using the QR code.



Built to last.*

STORAGE EQUIPMENT | DOORS | STEEL BUILDINGS
MADE IN SWEDEN | +46 371 340 00 | WWW.EAB.INFO

